

- R.010
- △ R.012
- ⊙ R.015
- × R.020
- ~ R.025
- * R.031
- ◇ R.040
- R.062

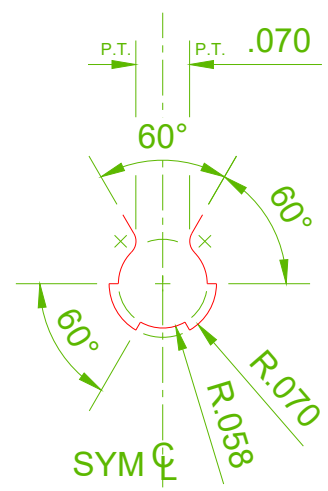

FULL SIZE

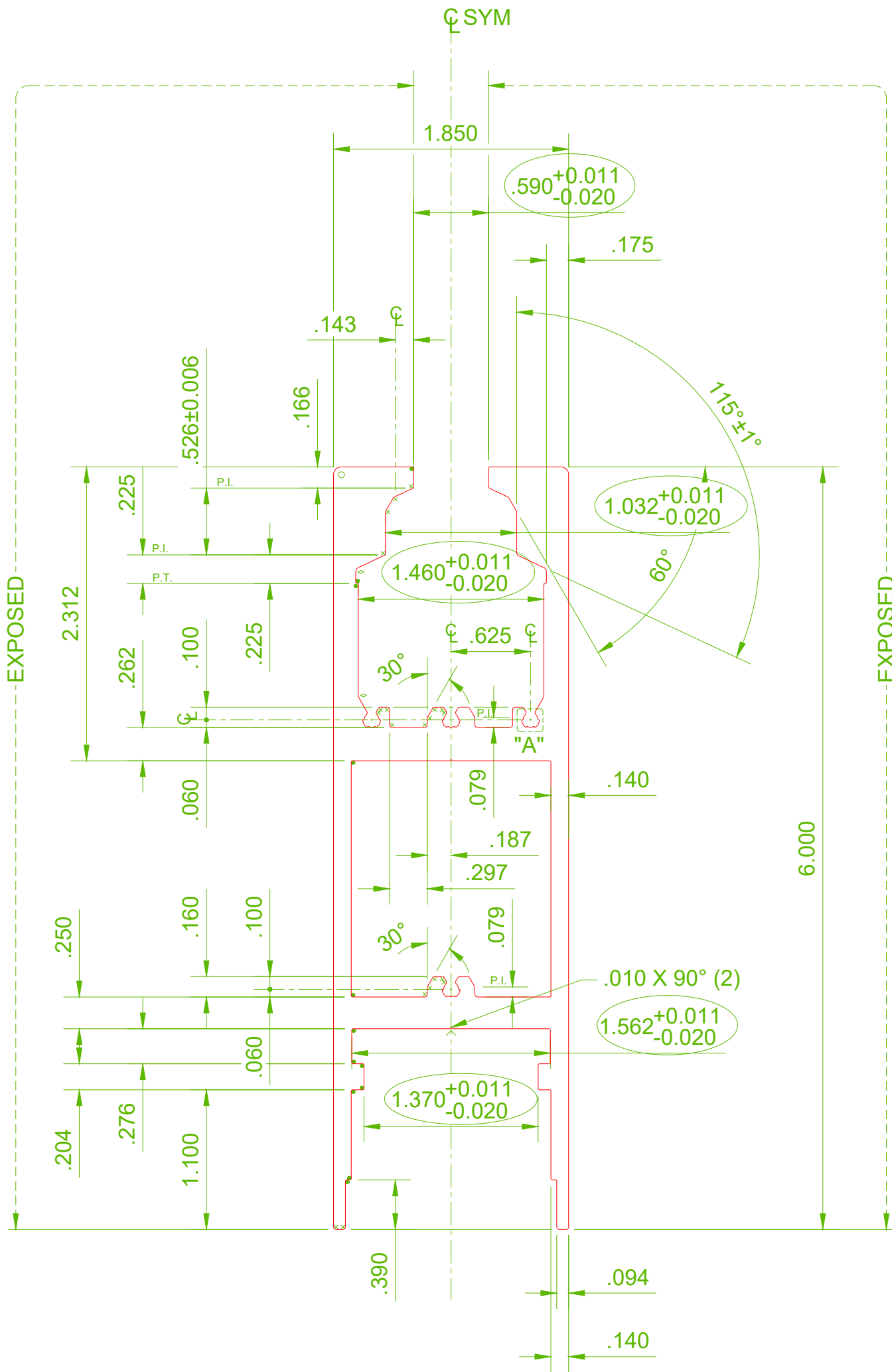

EXTRUSION NO R6S12EXT	DRAWN BY GLS	APPROVAL	DATE 02/15/21
DESCRIPTION 6" SQ DOOR RAIL HOUSING 1/2" GLASS			
NOTES 1) DARK BRONZE & SATIN HEAVY ETCH TYPE 1 ANODIZE, CLASS 1 THICKNESS 2 STEP ELECTROLYTIC DYE			

SYSTEM: ADVANCED FRAMELESS GLASS ENTRANCE	REV	DESCRIPTION	DATE	APP'D
ALLOY & TEMPER: 6063-T6				
EST AREA: 3.265	SQ. IN.			
EST WEIGHT / FT: 3.918	LB			
EST PERIMETER: 33.234	IN	EXP PERI: 13.242		
PAINTED PERI: 13.242	IN	OUT PERI: 25.806		
CLASS: HOLLOW	CIR SIZE: 6.259	UNLESS OTHERWISE SPECIFIED ANSI H35.2-2009 TOLERANCES FOR ALUMINUM EXTRUSIONS APPLY		
SECTION	lxx: IN	Sxx: IN	UNSPECIFIED CORNER RADIUS: .010 IN	
PROPERTIES: lyy: IN	Syy: IN	IDENTIFIES CRITICAL INSPECTION DIMENSIONS FOR FHC		
		---- IDENTIFIES EXPOSED AREA		
			PROPERTY OF FHC. USE OR COPIES OF THIS DRAWING AND THE DESIGN SHOWN THEREIN IS PROHIBITED WITHOUT WRITTEN CONSENT.	