

NEW

# FHC GrandVue®

Frameless Glass Wall System

## PROFESSIONAL GRADE

- » 3/4" Narrow Profile Flatbar Post Design
- » For use with 9/16" to 13/16" Laminated Tempered Glass
- » Great for Railing, Glass Wall Systems, and Windbreaks
- » Innovative Pressure Fit Clamp Design
- » No Glass Fabrication Required
- » High Quality 304 Grade Stainless Steel Construction
- » Designed for Interior and Exterior Applications
- » Available in End or Center Configurations
- » Surface Mount, Fascia Mount, and Core Mount Applications
- » Can be Customized to Meet Project Requirements, Contact FHC Technical Sales for More Information



Pressure Fit Glass Clamps  
for 9/16" to 13/16" Glass

CSI DIVISION 10

SECTION

10 7123

FHC's GrandVue® Frameless Glass Wall System is ideal for use around pool enclosures, rooftops, patios, windscreen and guardrail applications. The system provides a contemporary, all-glass look with 3/4" narrow sightline posts. Grandvue® Posts are made of 304 grade stainless steel and are available in brushed, polished, or custom powder coat finishes and will accept glass ranging from 9/16" to 13/16" thick. Contact FHC's Technical Sales for more information at (888) 295-4531 or email at [railing@fhc-usa.com](mailto:railing@fhc-usa.com).



The Glazing  
Supply Company

EXPERIENCE AND INNOVATION



2323 Firestone Blvd. South Gate, CA 90280  
Toll Free (888) 295-4531 | Fax (323) 336-8307  
email [railing@fhc-usa.com](mailto:railing@fhc-usa.com)  
[FHC-USA.COM](http://FHC-USA.COM)

## FHC GrandVue® Frameless Glass Wall Systems

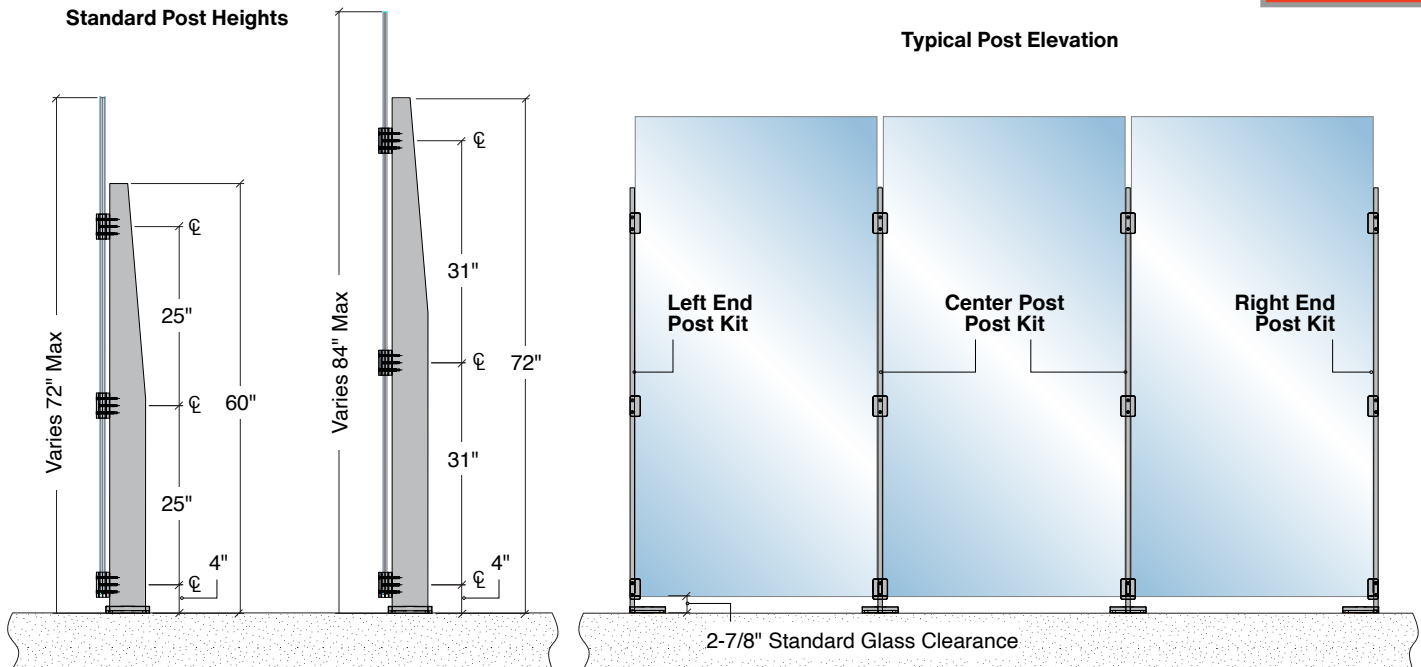
**NEW**

**60"**  
Tall Post Kits

**72"**  
Tall Post Kits

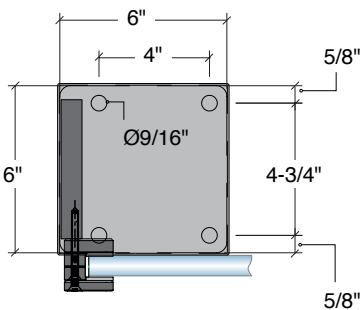

**Left End**  
3/8" Thick Base Plate  
With Cover

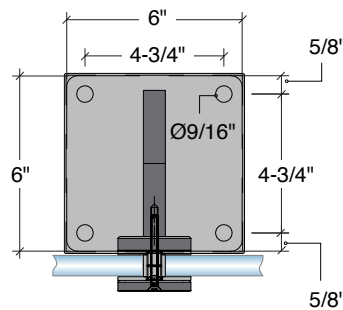

**Center Post**  
3/8" Thick Base Plate  
With Cover

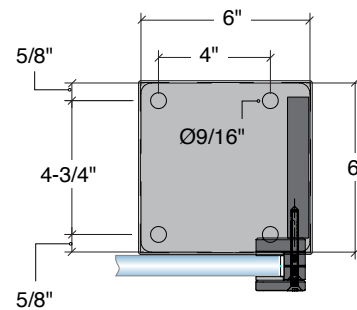

**Right End**  
3/8" Thick Base Plate  
With Cover

### Available Finishes



**BS**  
BRUSHED  
STAINLESS



**PS**  
POLISHED  
STAINLESS

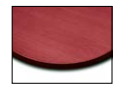

**PT**  
CUSTOM  
PAINTED  
FINISH

#### FHC GRANDVUE® 60" TALL POST KITS WITH GLASS CLAMPS

LEFT END POST KITS ITEM NO.	CENTER POST KITS ITEM NO.	RIGHT END POST KITS ITEM NO.	FINISH
GV60LEKBS	GV60CKBS	GV60REKBS	Brushed Stainless
GV60LEKPS	GV60CKPS	GV60REKPS	Polished Stainless

#### FHC GRANDVUE® 72" TALL POST KITS WITH GLASS CLAMPS

LEFT END POST KITS ITEM NO.	CENTER POST KITS ITEM NO.	RIGHT END POST KITS ITEM NO.	FINISH
GV72LEKBS	GV72CKBS	GV72REKBS	Brushed Stainless
GV72LEKPS	GV72CKPS	GV72REKPS	Polished Stainless



**MADE IN U.S.A.**

#### FHC GRANDVUE® SERIES PRESSURE FIT GLASS CLAMPS

END GLASS CLAMP ITEM NO.	LEFT END BOTTOM GLASS CLAMP ITEM NO.	LEFT END BOTTOM GLASS CLAMP ITEM NO.	CENTER GLASS CLAMPS ITEM NO.	BOTTOM CENTER GLASS CLAMPS ITEM NO.	GLASS THICKNESS	FINISH
GV12EBS	GV12LEBS	GV12REBS	GV12CBS	GV12BCBS	For 9/16" to 13/16"	Brushed Stainless
GV12EPS	GV12LEPS	GV12REPS	GV12CPS	GV12BCPS	For 9/16" to 13/16"	Polished Stainless

**FHC**  
**MANUFACTURING**  
DESIGNED & MANUFACTURED BY  
FRAMELESS HARDWARE COMPANY

LIT0232 REV. 05.17.23