

INSTALLATION INSTRUCTIONS
FHC HYDRAULIC PATCH FITTINGS

CSI DIVISION 08
 SECTION
08 4210

2-9/16" Setback 90 Degree Hold-Open Models
2-9/16" Setback 90 Degree No Hold-Open Models

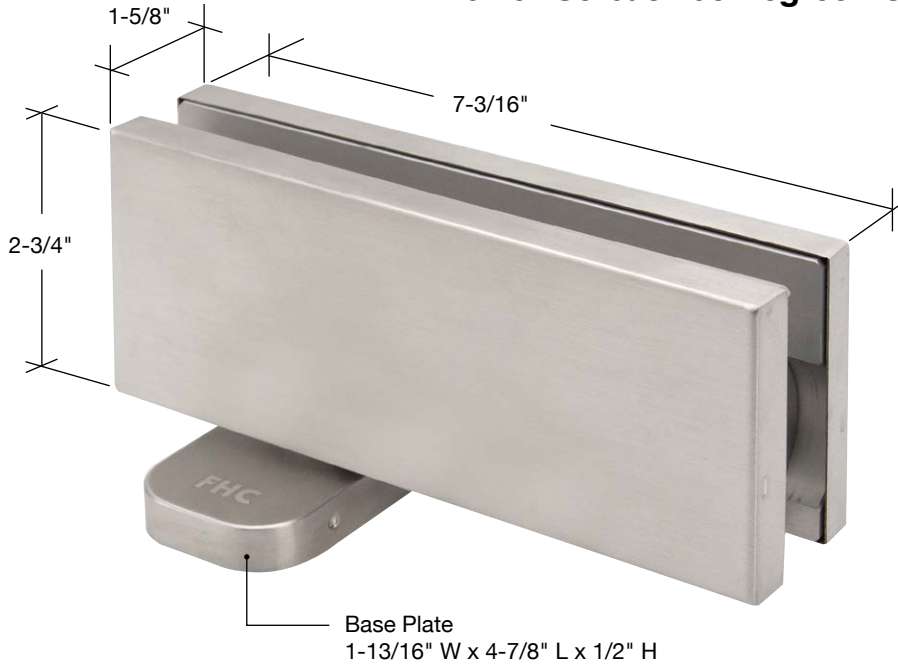

- For 3/8", 1/2", or 9/16 Tempered Glass
- 2-9/16" European Pivot Setback
- Hold-Open and No Hold-Open Models Available



or



USE MONOLITHIC
 TEMPERED GLASS

USE LAMINATED
 TEMPERED GLASS

ITEM NO.	DESCRIPTION
HPF90H0BS	90° Hold-Open Brushed Stainless Steel
HPF90H0PS	90° Hold-Open Polished Stainless Steel
HPF90H0SA	90° Hold-Open Satin Anodized
HPF90H0MB	90° Hold-Open Matte Black
HPF90NH0BS	90° No Hold-Open Brushed Stainless Steel
HPF90NH0PS	90° No Hold-Open Polished Stainless Steel
HPF90NH0SA	90° No Hold-Open Satin Anodized
HPF90NH0MB	90° No Hold-Open Matte Black

Minimum Order: 1 each.

CONTENTS:

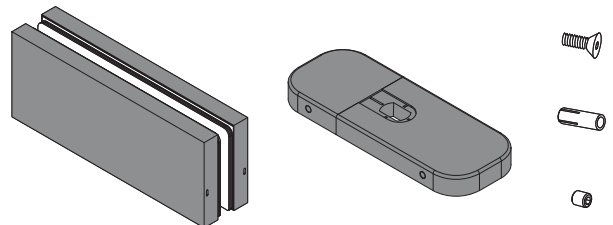

STEP 1: Hinge Layout

1. Mark hole positions using the Base Plate as a template.
2. Drill 3/8" diameter holes 1-3/8" deep.
3. Insert the concrete anchors using a 3/16" Dowel and a Rubber Mallet.
4. Fasten the Base Plate Into place using the included Screws.

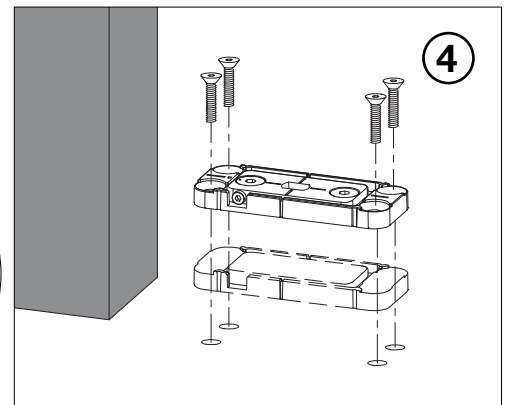
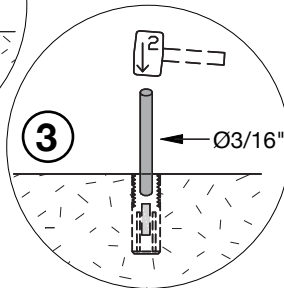
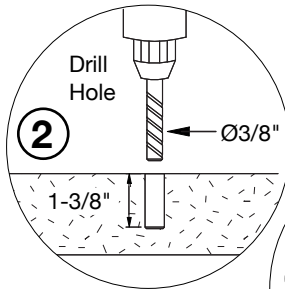
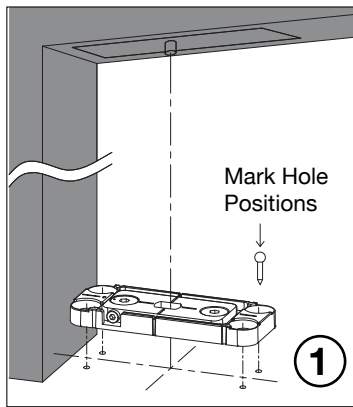
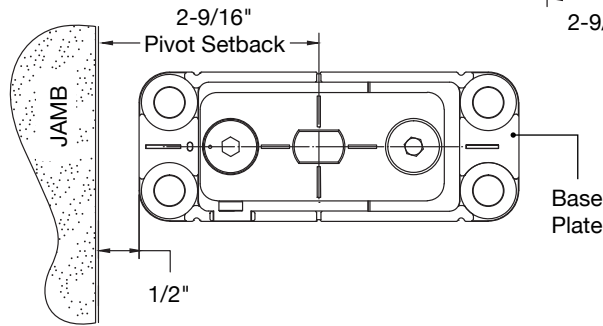
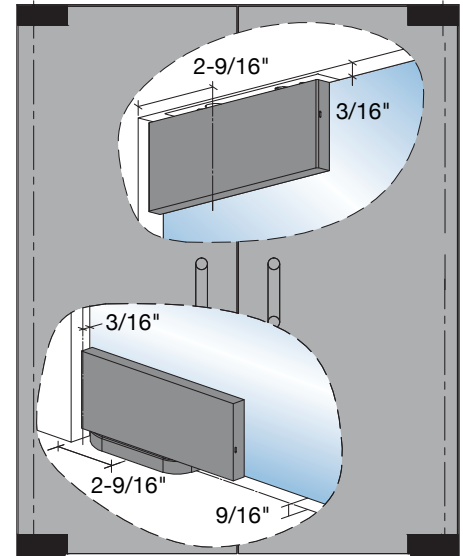
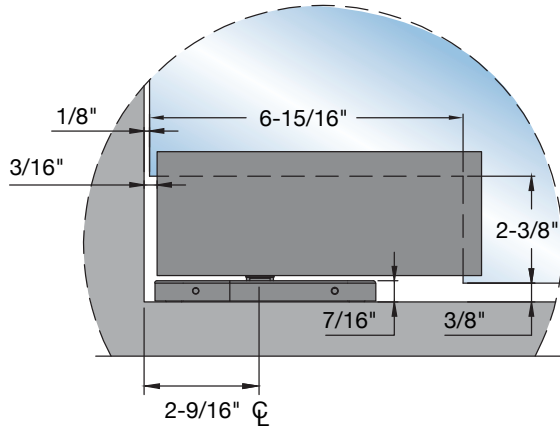

STEP 2: Hinge Adjustments

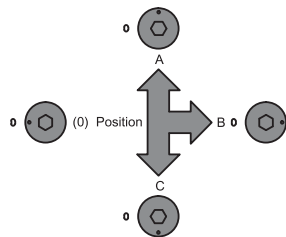
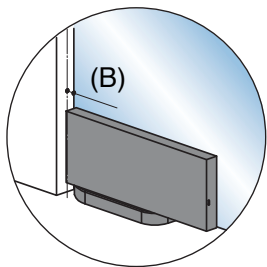

Turn the (0) Position to
A = Center Position +1 mm
B = Increases gap of the door and jamb +2 mm
C = Center Position +3 mm

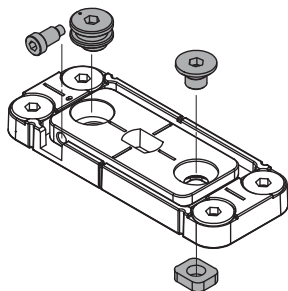
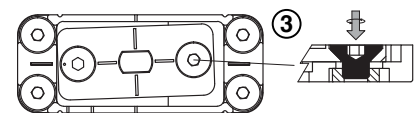
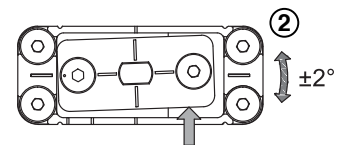
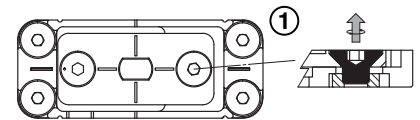

Loosen the Screws shown, make adjustments to Base Plate and re-tighten the Screws.

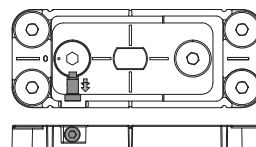

STEP 3: Inserting Glass Gaskets

For 3/8" (10 mm) Glass

1/6" = White

1/8" = Aluminum

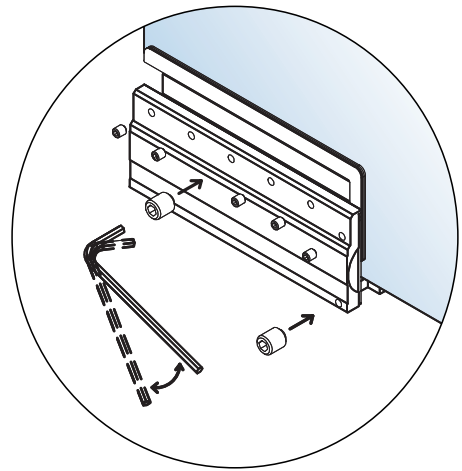
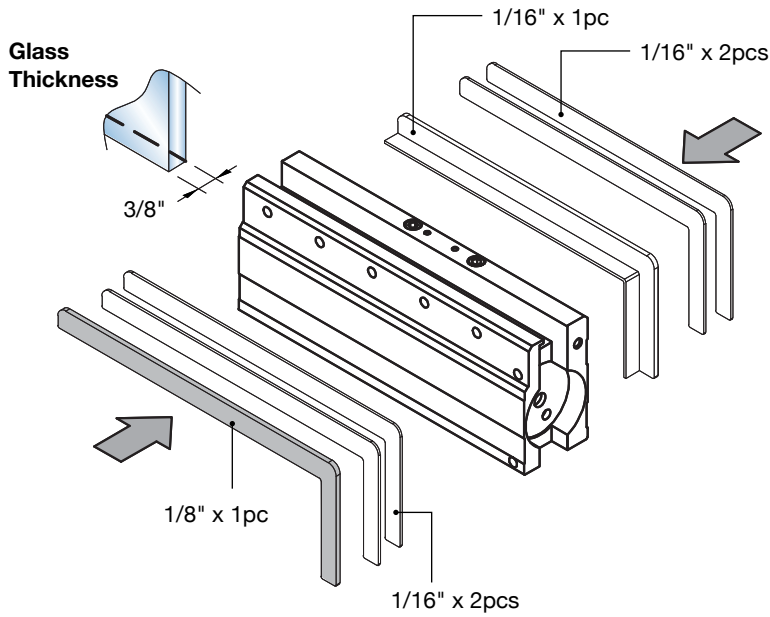

Insert the Patch Fitting with Gaskets into the glass cut-out and attach with set screws included.

For 1/2" and 9/16 (12 and 13.52 mm) Glass

1/6" = White

1/8" = Aluminum

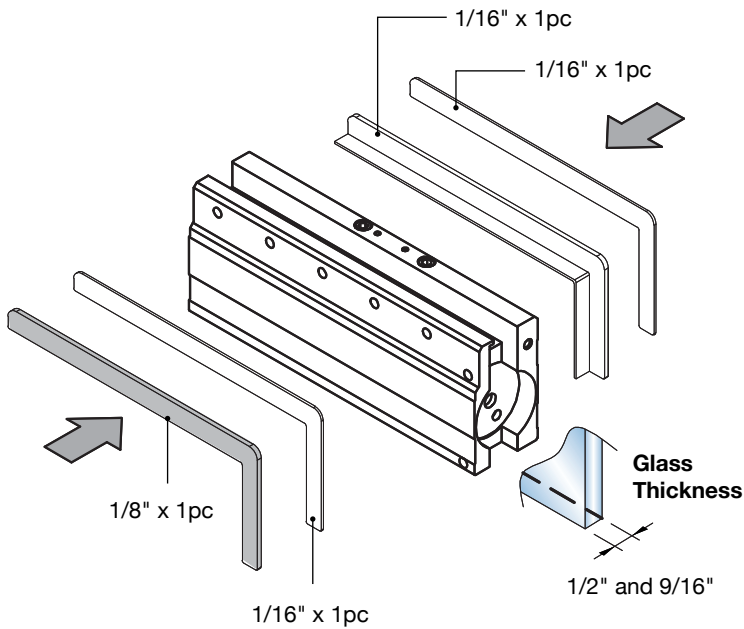

STEP 4: Install the Door at an angle into the Bottom Base Plate

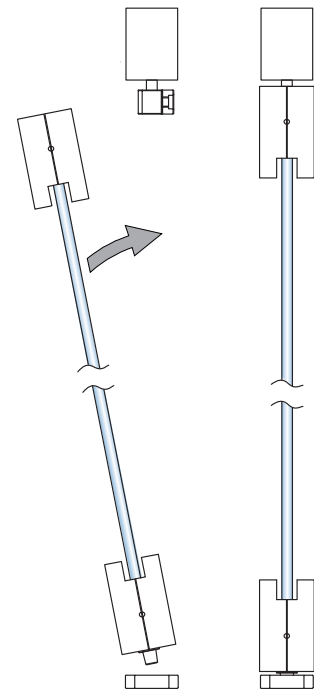

STEP 5: Adjustments

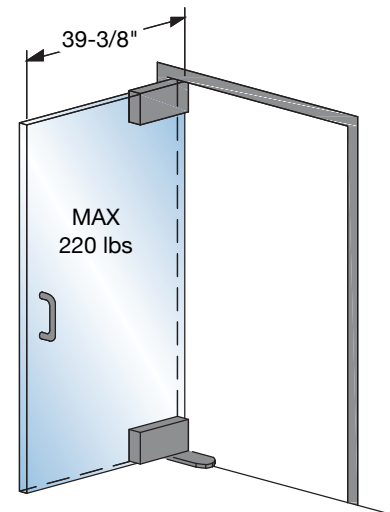
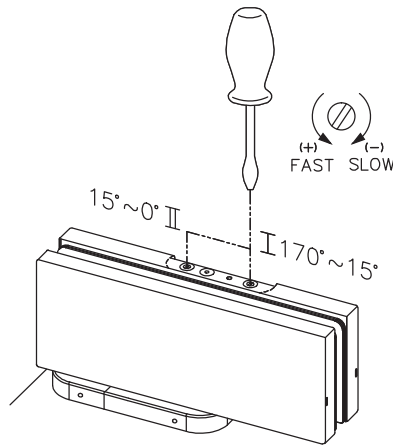
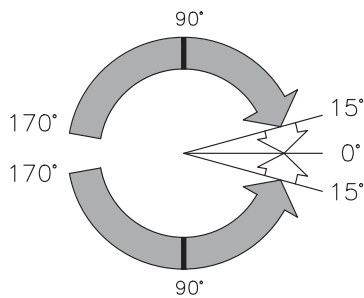

Glass Thickness
3/8", 1/2", and 9/16"

Adjustment of closing speed:

- Two Regulating Valves (I) and (II)
- ⌚ Decrease Speed
- ⌚ Increase Speed
- Valve (I): Control Closing Range 170° to 15°
- Valve (II): Control Closing Range 15° to 0°

STEP 6: Attaching the Covers

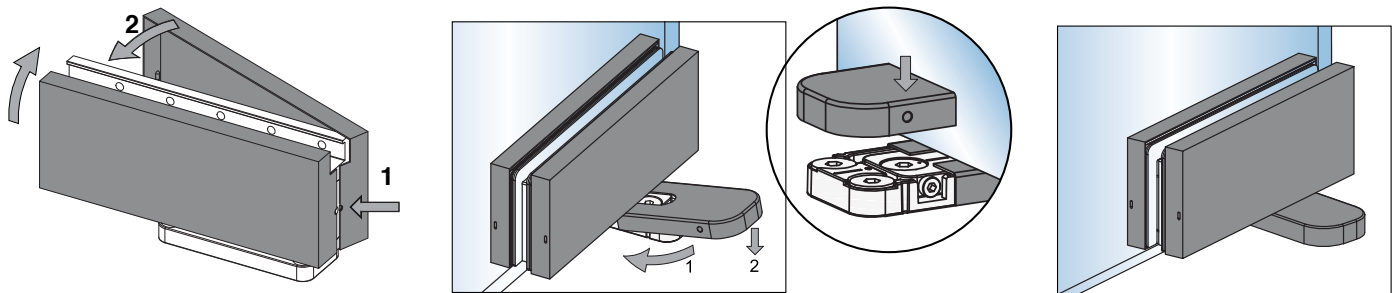

Removing the Door

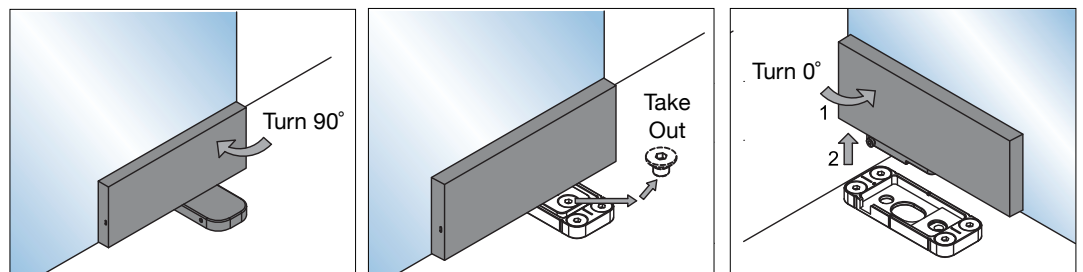

Important Installation Notes:



AFTER INSTALLATION, PLEASE CHECK & TEST:

1. Open the Door Leaf to its maximum opening angle and release. The Door Leaf should close fully into the door frame and overcome the latch.
2. Open the Door Leaf and rest the latch bolt on the striker plate. Release the Door Leaf. The door closer should have sufficient power to latch the Door Leaf closed.



MAINTENANCE:

1. Check the door closer every three months to ensure all fixings are secure. If necessary, adjust the closing and latching speed and mark the door operating both functionality and smoothly.
2. Apply light oil to arm knuckle joint and door hinges.

GLASS SPECIFICATIONS:

MAXIMUM HEIGHT	102" (2591 mm)
MAXIMUM WIDTH	39-3/8" (1000 mm)
MAXIMUM WEIGHT	220 lbs (100 kg)

