

FHC TOP JAMB INSTALLATION CLOSER MOUNTED TOP JAMB ON PUSH SIDE OF DOOR

STANDARD INSTALLATION CLOSER MOUNTED ON PULL SIDE OF DOOR

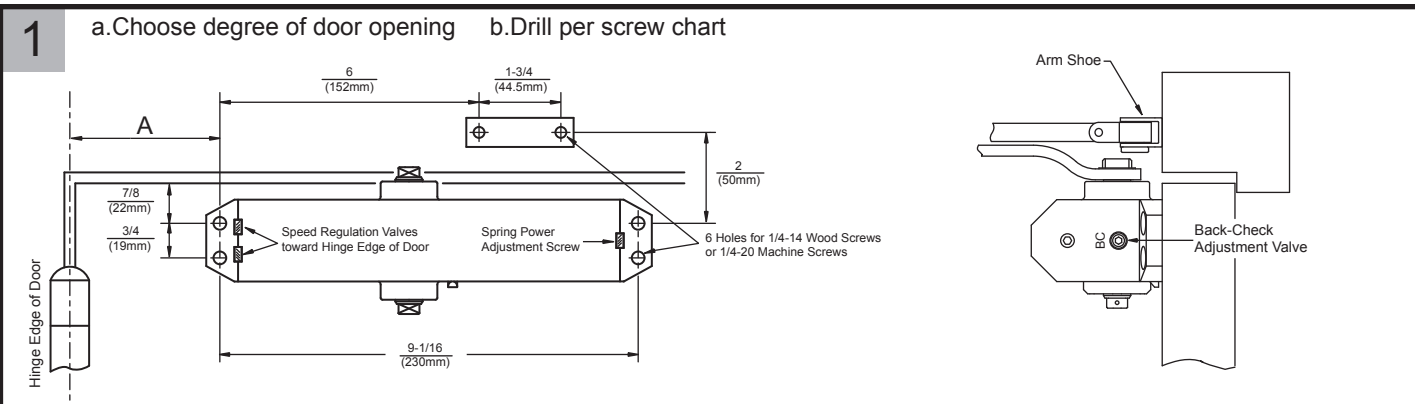
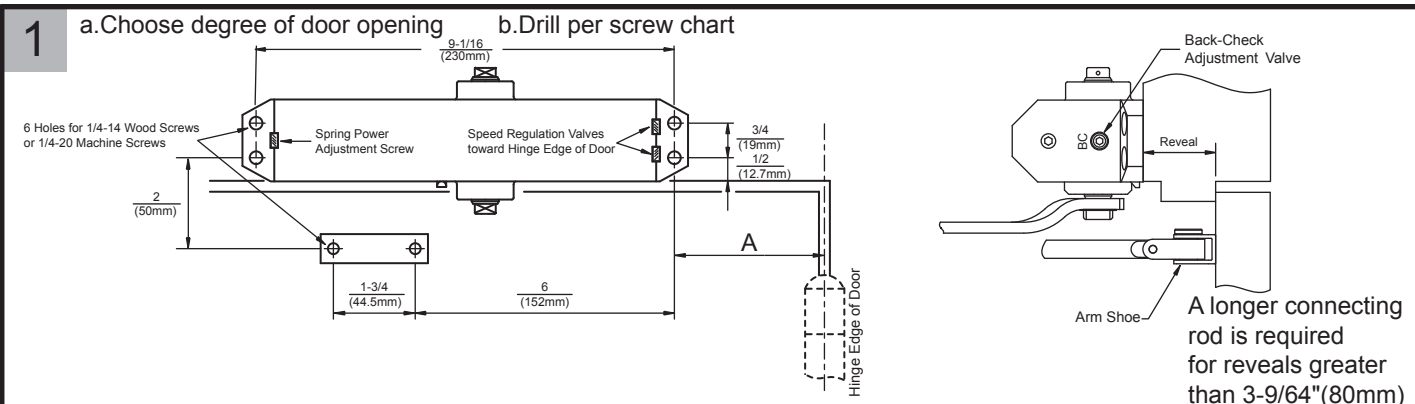

RIGHT HAND DOOR ILLUSTRATED

Opening Inches (mm)	Dimension A	
	Inches	mm
TO 100°	7	(178)
TO 120°	6	(152)
TO 180°	3-1/2	(89)

Adjust spring power to match chart

Opening	Closer Size	Clockwise Turns Of Adjustment Screw
TO 100°	V	12
	IV	6
	III	0
TO 120°	IV	12
	III	6
	II	0
TO 180°	III	12
	II	6
	I	0

Door Closer Size I is not covered by CAN/ULC S133 since it is not intended for use with swinging doors in fire separations and on exit doors.

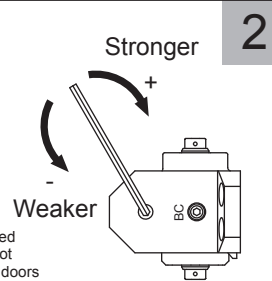

RIGHT HAND DOOR ILLUSTRATED

Opening Inches (mm)	Dimension A	
	Inches	mm
TO 100°	7	(178)
TO 120°	6	(152)
TO 180°	3-1/2	(89)

Adjust spring power to match chart

Opening	Closer Size	Clockwise Turns Of Adjustment Screw
TO 100°	V	12
	IV	6
	III	0
TO 120°	IV	12
	III	6
	II	0
TO 180°	III	12
	II	6
	I	0

Door Closer Size I is not covered by CAN/ULC S133 since it is not intended for use with swinging doors in fire separations and on exit doors.

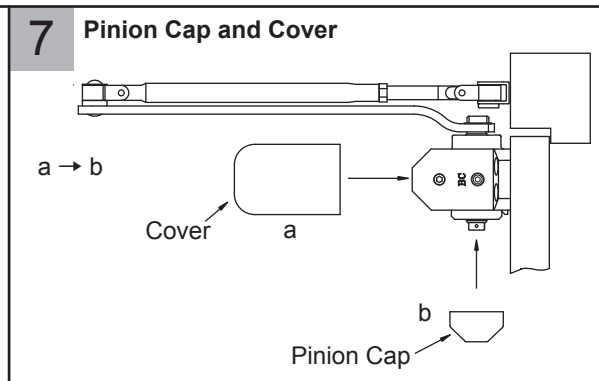
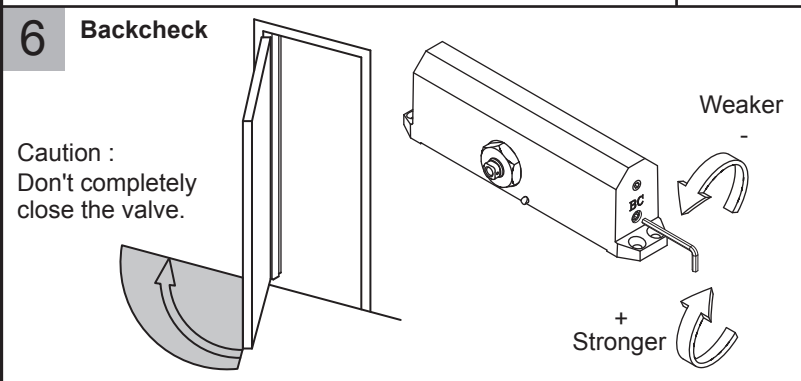
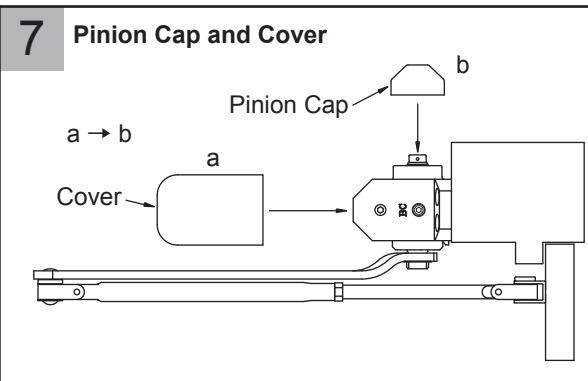
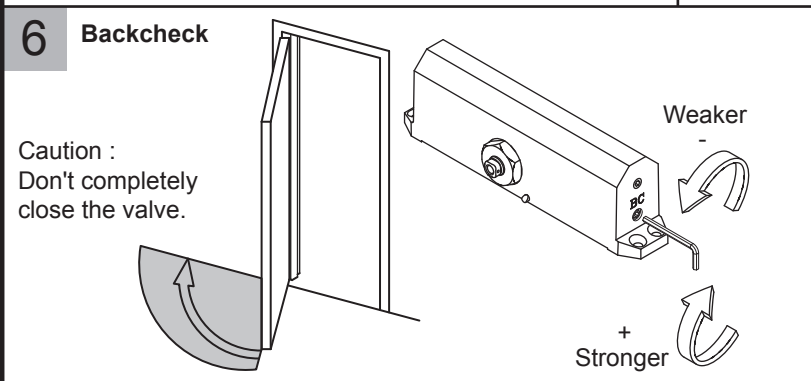
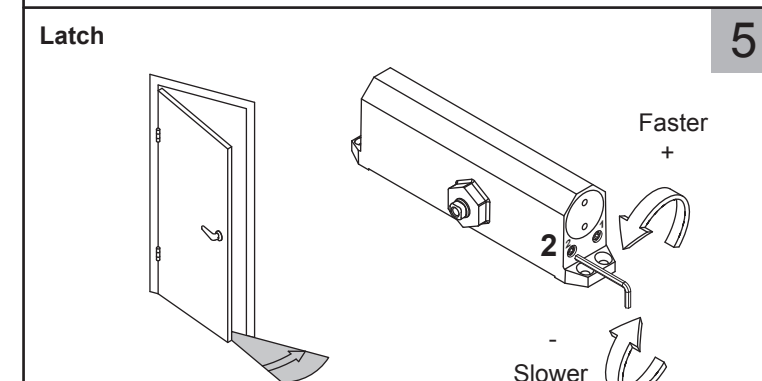
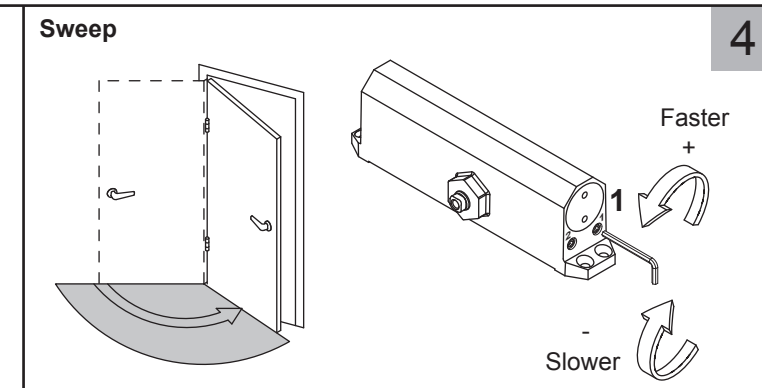
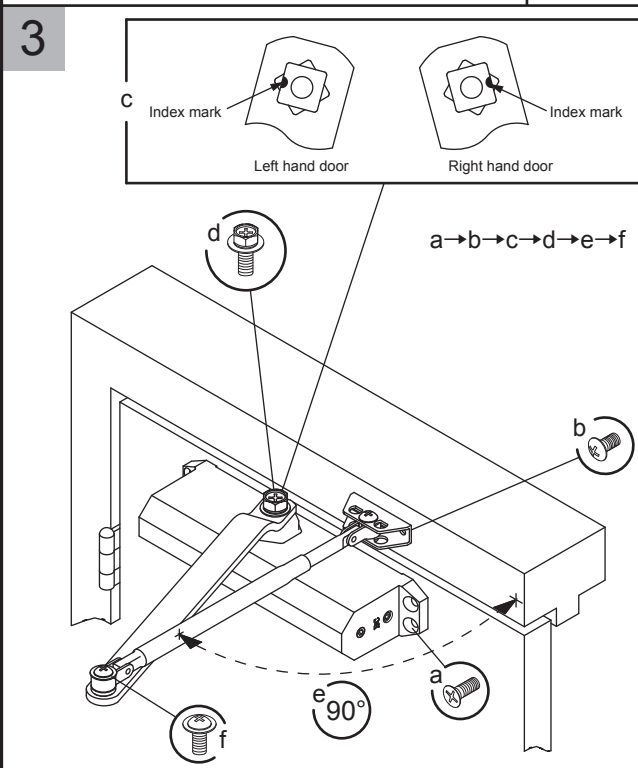
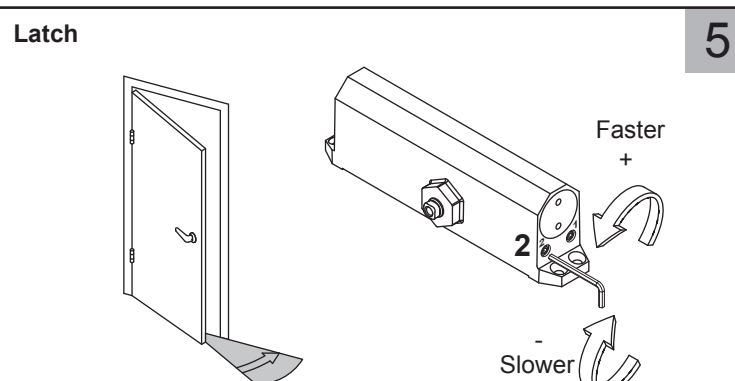
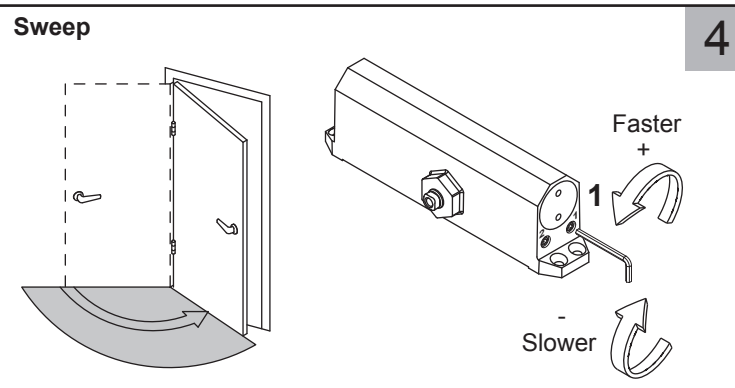
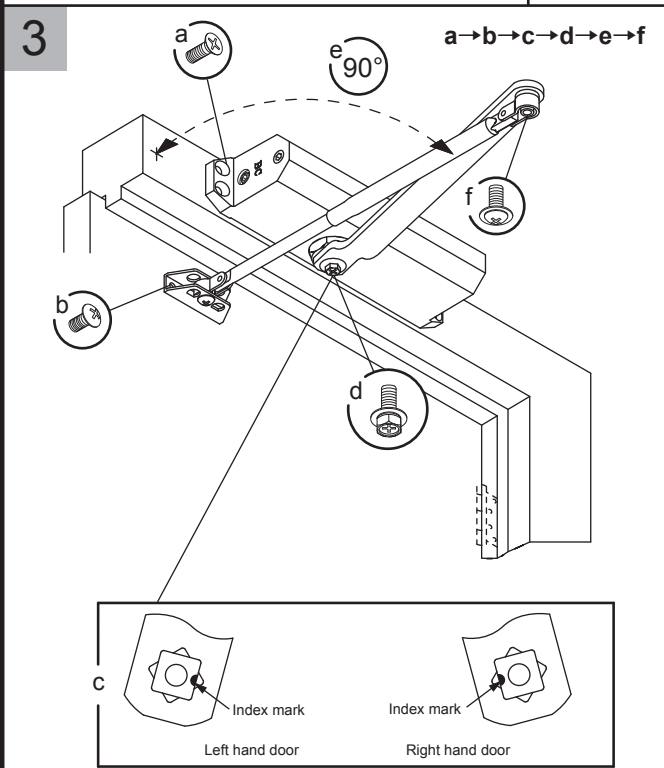
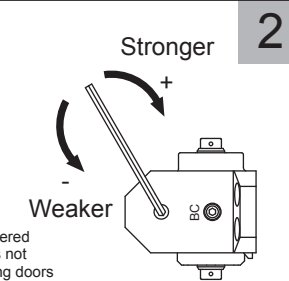

1 a. Choose degree of door opening b. Drill per screw chart.

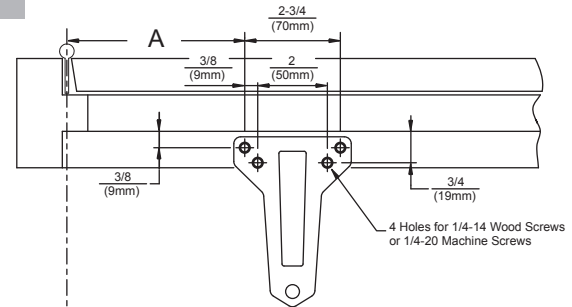

LEFT HAND DOOR ILLUSTRATED

Opening	Dimension	
	A	B
TO 100°	9-1/4 (235)	7-5/8 (194)
TO 120°	7-3/4 (197)	6-1/8 (156)
TO 180°	5-3/4 (146)	4-1/8 (105)

Inches (mm)

Adjust spring power to match chart.

Opening	Closer Size	Clockwise Turns Of Adjustment Screw
TO 100°	IV	12
	III	6
	II	0
TO 120°	IV	12
	III	6
	II	0
TO 180°	III	12
	II	6
	I	0

Door Closer Size I is not covered by CAN/ULC S133 since it is not intended for use with swinging doors in fire separations and on exit doors.

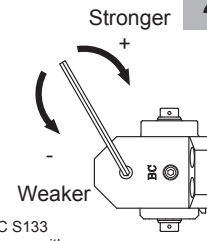

2

Pull Side Installation

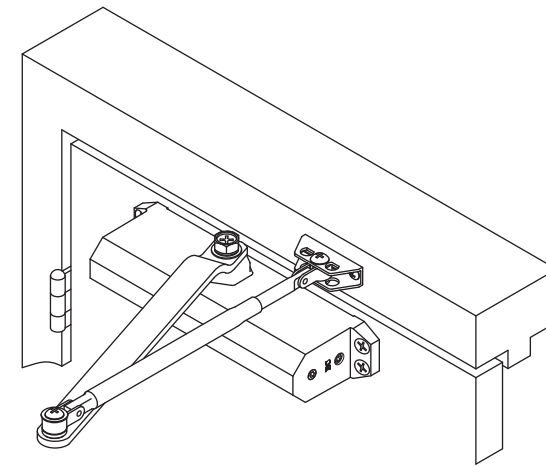

Push Side Installation

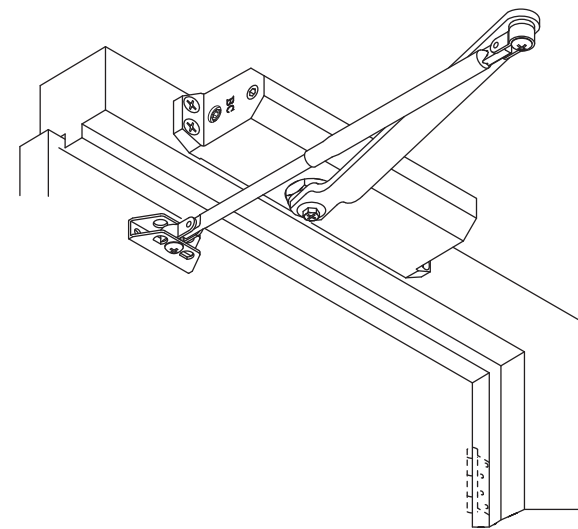

Parallel Arm Installation

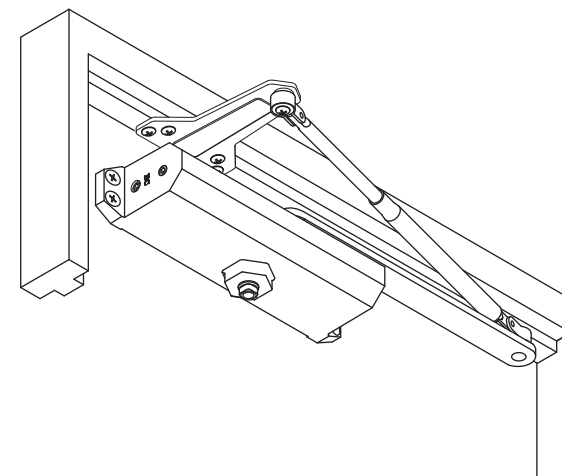

DOOR CLOSER INSTALLATION INSTRUCTION

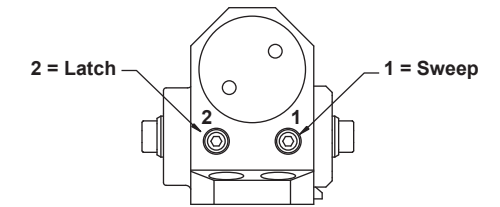

Spring Power Adjustment Screw

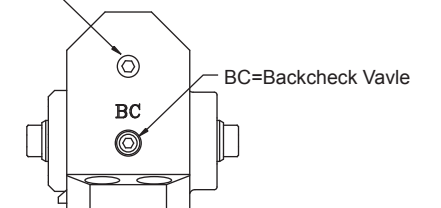

Regular Arm & Top Jamb				
Max. Door Size [Inches (mm)]	30"(762)	36"(914)	42" (1067)	48" (1219)
Interior	Size I	Size II	Size III	Size IV
Exterior	Size III	Size IV	Size V	NA

Note: 1. Indicates recommended application of door width for closer size. Determine door width, adjust spring power to match chart.
2. For parallel arm application, it requires to adjust more spring power to meet door width.

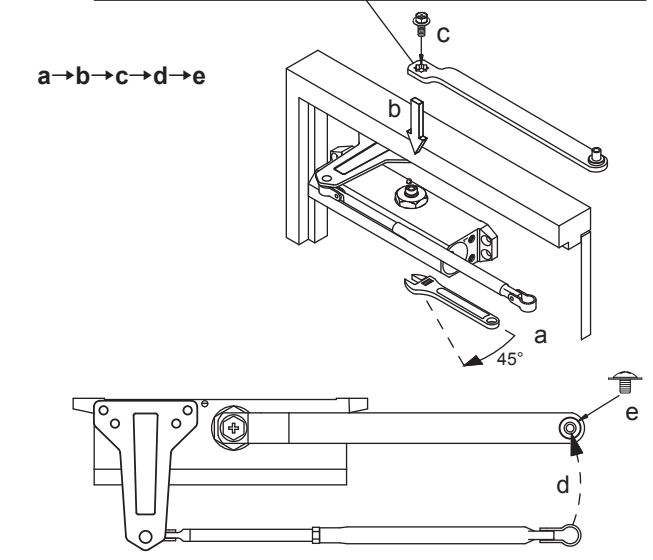
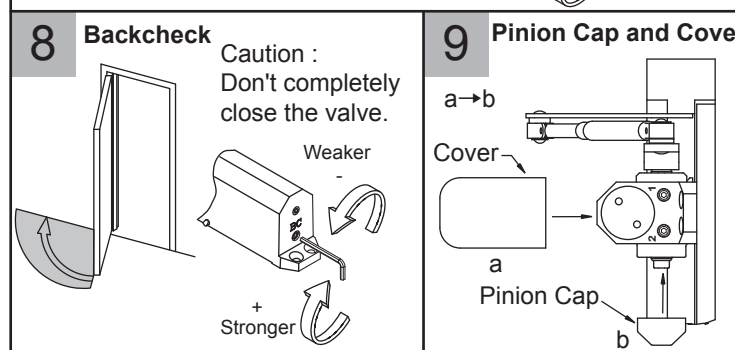
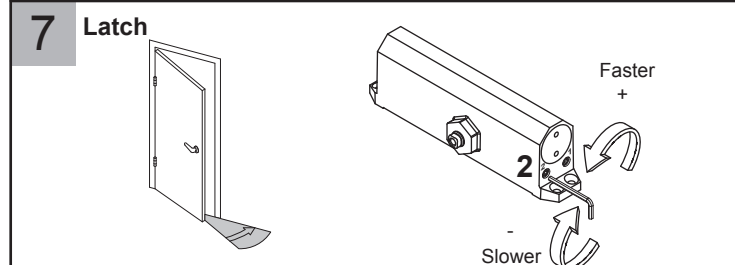
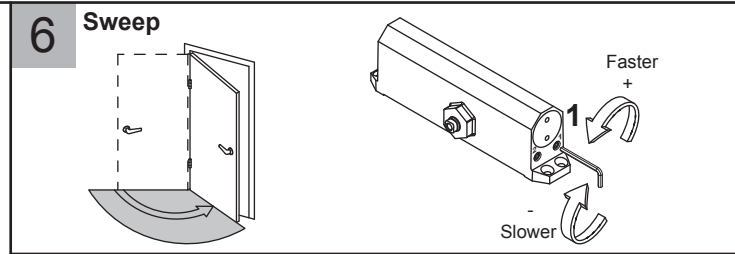
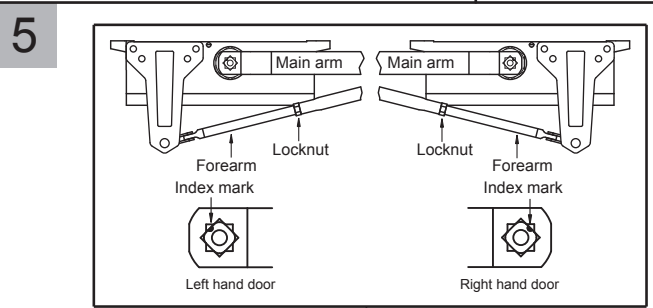
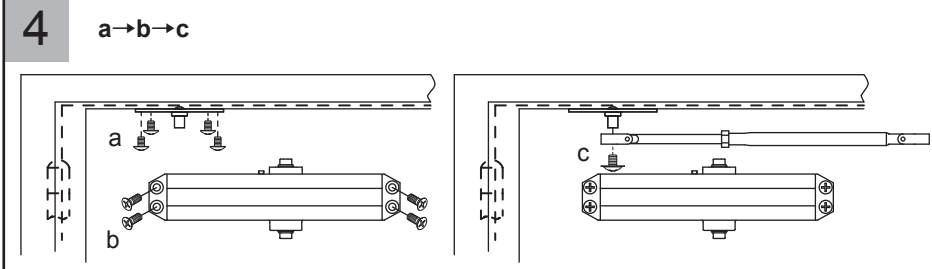
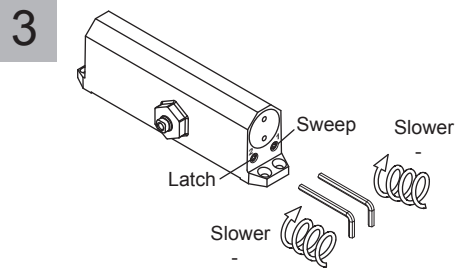

Standard Components

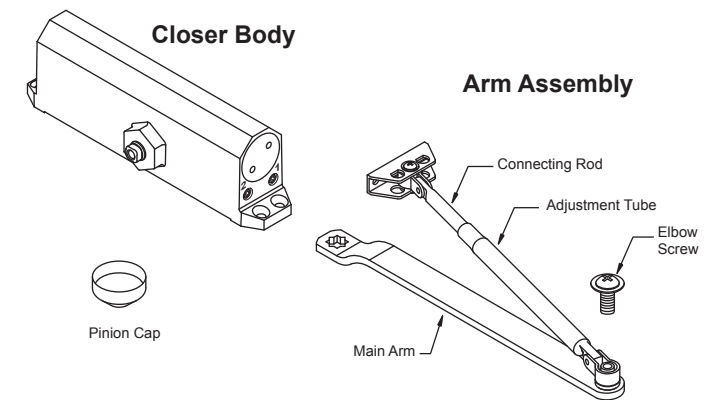

Soffit Plate

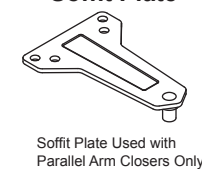

Optional Components

