

FHC HEAVY-DUTY K.D. EXTRUDED SLIDING SCREEN DOOR KITS

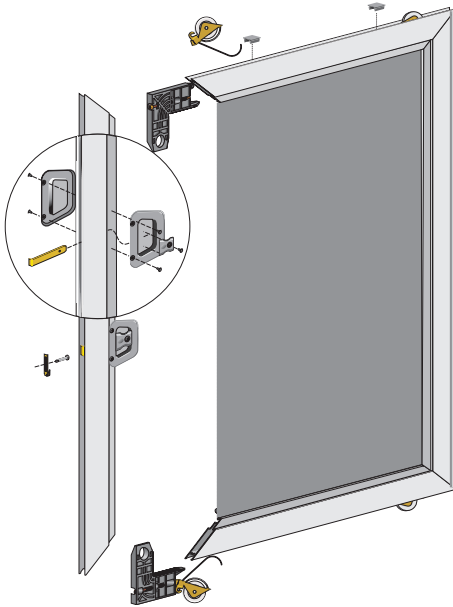

- Easy Assembly and Installation
- Heavy-Duty Extruded Aluminum
- 81" and 96" Height Kits
- Adjustable Corner Key and 1-1/4" Steel Roller Assembly
- Easily Cut to Fit Any Height
- 1-1/8" Maximum Cut on the Width
- Available in Satin Anodized, Black, Bronze and White Finishes
- Ships UPS
- Screen Wire Mesh Sold Separately

81" HEIGHT ITEM NO.	96" HEIGHT ITEM NO.	WIDTH	FINISH
KDX3081A	---	30.5"	Satin Anodized
KDX3081BL	---	30.5"	Black
KDX3081BRZ	---	30.5"	Bronze
KDX3081W	---	30.5"	White
KDX3681A	KDX3696A	36.5"	Satin Anodized
KDX3681BL	---	36.5"	Black
KDX3681BRZ	KDX3696BRZ	36.5"	Bronze
KDX3681W	KDX3696W	36.5"	White
KDX4881A	KDX4896A	48.5"	Satin Anodized
KDX4881BL	KDX4896BL	48.5"	Black
KDX4881BRZ	KDX4896BRZ	48.5"	Bronze
KDX4881W	KDX4896W	48.5"	White
KDX6081A	KDX6096A	60.5"	Satin Anodized
KDX6081BL	KDX6096BL	60.5"	Black
KDX6081BRZ	KDX6096BRZ	60.5"	Bronze
KDX6081W	KDX6096W	60.5"	White

Minimum order: 1 each.

STEP 1

Find the door's height by measuring from the top of the screen door roller track on the bottom sill to the inside of the screen door top channel, then subtract 1/4" from this measurement (*Figure A*).

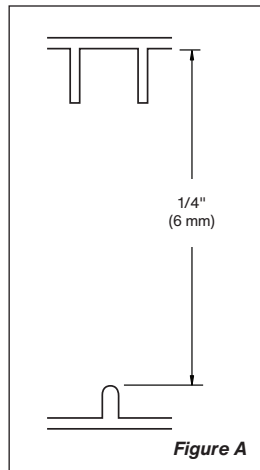

STEP 2

The new kit comes with top and bottom rails that are each 1/2" longer than the standard door width (e.g., a 36" door will measure 36-1/2" wide). Additionally, the door roller slot has been expanded by 1/2", allowing adjustment of the door width from 36-1/2" to 35-1/2". It is crucial to note that both ends of the door rails should only be cut by a maximum of 1/2".

STEP 3

Identify the door stile with the handle punch. The internal handle features a vertical latch slide and is positioned opposite the spline side. When installing the door, ensure the door face with the spline groove is always facing outward.

STEP 4

If adjustments are needed for the 81" or 96" tall door stiles to fit the opening, take into account your handle height preference. Handles are centrally positioned on the punched door stiles. Consider the door's closing direction. If you prefer a lower handle height, trim the bottom part of the door stile to achieve the required door height.

STEP 5

If you have to reduce the height of your door stiles, you will need to re-drill the adjustment screw hole on the cut end of the stile. Place the stile on its side, spline side down, and drill a new hole with a 3/8" drill bit 7/8" from the end of the stile, ensuring you drill through the outer wall only (*Figure B*).

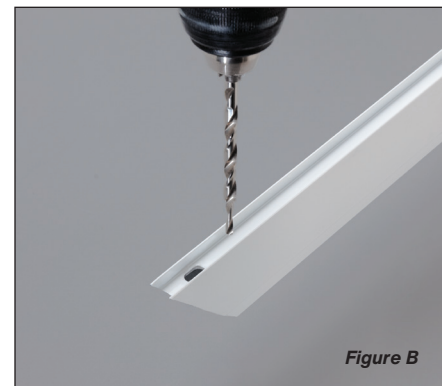

STEP 6

Assemble the door by sliding the door stiles onto the pre-installed corners on the top and bottom door rails (*Figure C*).

**STEP 7**

Position the door frame with the spline groove facing upwards on a flat surface. Install the screen using either serrated vinyl spline or foam core spline along with a spline rolling tool. Preferably, use a .135" diameter for standard 18 X 16 mesh fiberglass. Smaller spline diameters may be required for thicker pet screen or solar screens.

STEP 8

Once the door is screened, install the outer black plastic pull (the pull without the latch slide). Turn the door over and loosely fit the inner handle. Slide the steel latch into the slot along the door edge, ensuring the latch fits into the slide of the inner pull. Secure the flat head screw through the slide into the steel latch and proceed to tighten the pull handle screws, being cautious not to over tighten (*Figure D*).

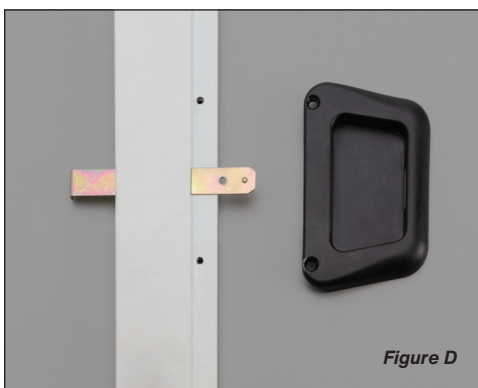
**STEP 9**

Place the screen door into the glass door frame opening. You may need to loosen the adjustment screws so the bottom rollers retract sufficiently to clear the bottom screen track.

STEP 10

Slide the door towards the jamb and verify the alignment. Adjust the rollers to ensure that the door edge fits snugly against the jamb.

STEP 11

Install the latch keeper by lifting the latch slide upward and moving the door close to the jamb. Make a small mark on the jamb aligned with the bottom of the steel latch. Position the keeper (open side facing up) approximately 1/8" below the mark.

STEP 12

Close the door and lower the latch so that it engages with the keeper.

STEP 13

For installing the bug strip, start from the top and insert the square portion of the bug strip into the slot on the edge of the door. **NOTE:** the bug strip should not contact the glass. If the flap of the bug strip is too wide, trim it carefully with scissors and remove any excess strip along the tear line in the bug strip extrusion. Continue pushing the bug strip into the groove downward until all of it is fitted. Consider trimming the bug strip near the glass door frame to prevent it from rubbing against the top and bottom aluminum frame portions.

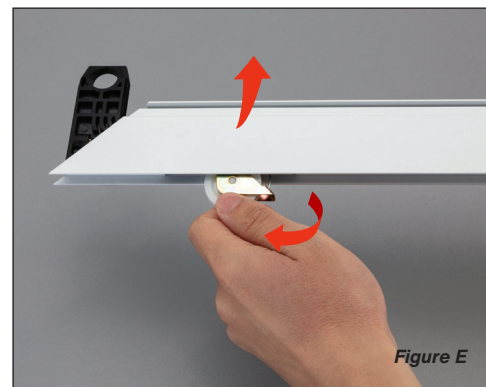
**REMOVING ROLLERS**

To remove the door rollers from the top or bottom rails, firmly grip the roller and pull it partially out of the opening. The roller will pivot around the corner. Once the roller sticks straight out of the slot after pivoting as much as possible, push it straight back into the slot (do not let it pivot back). You will feel the roller housing "pop," indicating that the attachment ears on the steel housing have disengaged from the corner retainer pins. The roller can now be easily removed from the rail slot. Reinstall by following the reverse procedure (*Figure E*).